



The e-GS 4" Range

e-GS BOREHOLE PORTFOLIO HAS BEEN REDESIGNED WITH OPTIMIZED HYDRAULICS
COMPLIANT WITH THE ERP DIRECTIVE.

CAPACITIES UP TO	22 m ³ /h
HEAD UP TO	310 m
POWER UP TO	0.37 kW TO 7.5 kW

ErP Ready.

The complete GS borehole pump series has been redesigned with high efficiency hydraulics, and MEI values above the ErP 2015 requirements.

During the redesign of this range changes have been made to the pump curves. These pumps may now not be a direct comparison for a replacement pump, so please check your duty point before making a selection.

Applications:

Domestic / Industrial water supply

Fire fighting

Food & Beverage

Geothermal

HVAC

Irrigation / Agricultural

Compliant with the ErP directive

Compact

Redesigned and optimized hydraulics

Reliability

Lower lifecycle costs

High resistance to corrosion

Lower energy costs

Stainless steel structure

All components are FDA compliant

Hexagonal pump shaft guarantees effective impeller drive

Variable speed offering either with the resiboost or the hydrovar

Motors.

Different voltages and frequencies available as options.

Mining / Drainage / Dewatering

Municipal water supply

Water displays / Fountains / Features



Abrasion resistant construction combined with floating impellers ensures optimum resistance to wear (maximum permissible quantity of sand 150 g/m³) making this one of the best pumps on the market for sand handling capabilities.

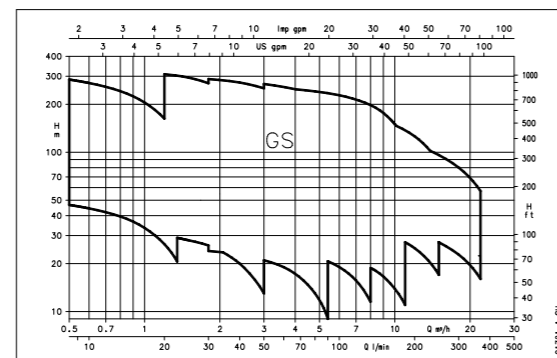

Construction materials:

Check Valve Type	Stainless Steel
Discharge Head	Stainless Steel
Motor Adapter	Stainless Steel
Diffuser	PC / PPO + PS
Bowl	Stainless Steel
Impeller	PC / PPO + PS
Strainer	Stainless Steel
Hex Shaft	Stainless Steel
Casing	Stainless Steel
Cable Guard	Stainless Steel
Bearing	Engineered Polymer
Elastomers	NBR



Lowara exclusive and proven floating stack hydraulic design.

Benefits of a floating stack:

Allows sand and abrasives to pass easily.

Rotating components are not in contact therefore parts will not wear resulting in extended life and sustained performance over time.

Impeller material is a reliable, proven polymer material to overcome abrasion damage.

Dual surface trust washer which prevents rubbing of components during start up.

Diffuser and impeller materials have a high abrasion resistance for longer life in harsh applications.

Stainless steel parts which provide maximum corrosion resistance for longevity.

Complete data and pump selection is available from our pump selection software.
www.xylect.com



In order to view the how-to videos, please visit www.youtube.com/user/xylect.

Complete range of accessories to suit such as cable, control panels, expansion tanks, filters, UV systems, Variable Speed Drives (VSD), jointing kits, cooling shrouds and flow meters.

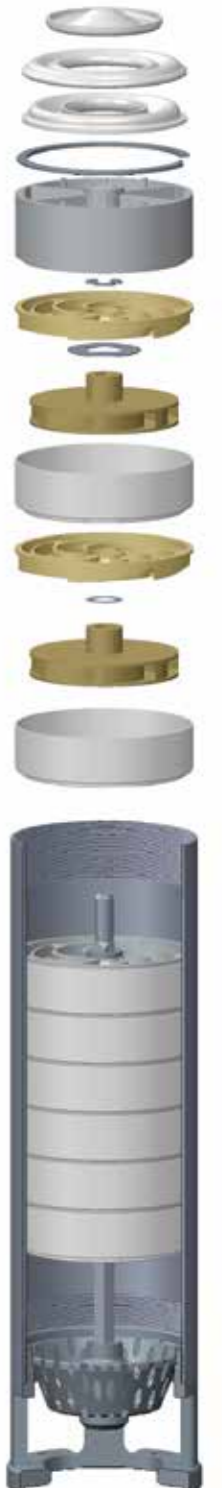

1GSL SERIES OPERATING CHARACTERISTICS AT 50 Hz

PUMP TYPE	N. OF STAGES	MOTOR POWER		Q = DELIVERY						
				l/min	0	8,3	10	15	20	22,5
				m ³ /h	0	0,5	0,6	0,9	1,2	1,35
				H = TOTAL HEAD METRES COLUMN OF WATER						
1GSL02 ⁽¹⁾	8	0,37	0,5	53	46,6	45	37	27	20,6	
1GSL03	12	0,37	0,5	79,4	69,9	67	55	40	30,9	
1GSL05	18	0,55	0,75	119	105	100	83	60	46,3	
1GSL07	24	0,75	1	159	140	133	110	80	61,7	
1GSL11	35	1,1	1,5	232	204	194	160	116	90	
1GSL15	49	1,5	2	324	285	272	224	163	126	

(1) Maximum pump absorbed power: 0,25 kW - 0,33 HP.

1gsl-2p50-en_c_th

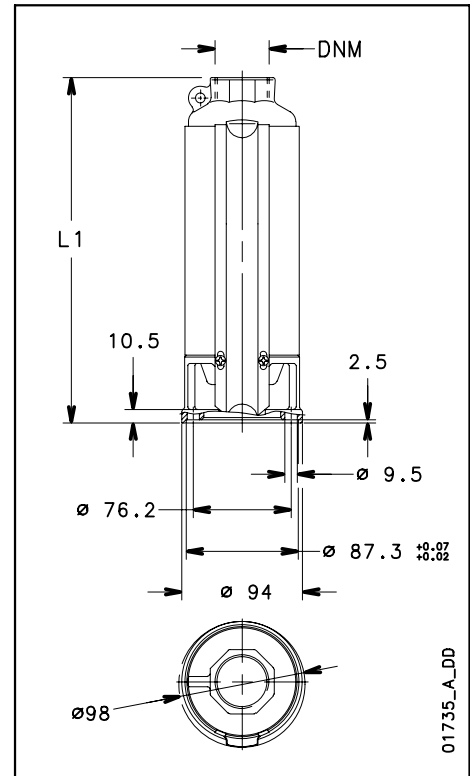

01735_A_DD

1GSL..4OS SERIES DIMENSIONS AND WEIGHTS

ELECTRO PUMP TYPE *	N. OF STAGES	DNM	DIMENSIONS (mm)		PUMP WEIGHT kg	ELECTRO PUMP WEIGHT kg
			L1	L		
1GSL02M-4OS	8	Rp 1 1/4	298	651	3,1	10,7
1GSL03M-4OS	12	Rp 1 1/4	369	722	3,9	11,5
1GSL05M-4OS	18	Rp 1 1/4	472	825	4,9	13,1
1GSL07M-4OS	24	Rp 1 1/4	578	956	5,8	15,1
1GSL11M-4OS	35	Rp 1 1/4	824	1237	8,7	19,9
1GSL15M-4OS	49	Rp 1 1/4	1068	1516	11,8	24,6
1GSL03T-4OS	12	Rp 1 1/4	369	701	3,9	11
1GSL05T-4OS	18	Rp 1 1/4	472	825	4,9	12,5
1GSL07T-4OS	24	Rp 1 1/4	578	931	5,8	14
1GSL11T-4OS	35	Rp 1 1/4	824	1202	8,7	18
1GSL15T-4OS	49	Rp 1 1/4	1068	1481	11,8	23,2

1gsl-4os-2p50-en_a_td

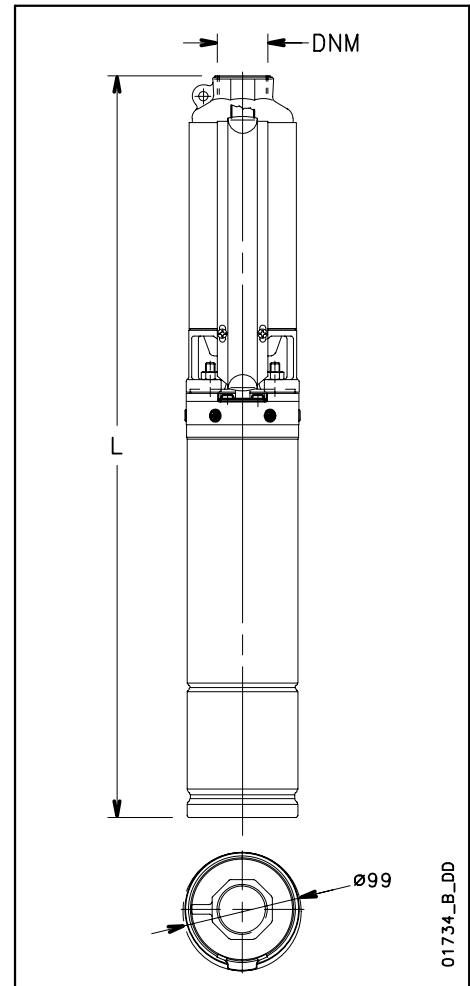

01734_B_DD

1GSL..L4C SERIES DIMENSIONS AND WEIGHTS

ELECTRO PUMP TYPE	N. OF STAGES	DNM	DIMENSIONS (mm)		PUMP WEIGHT kg	ELECTRO PUMP WEIGHT kg
			L1	L		
1GSL02M-L4C	8	Rp 1 1/4	298	532	3,1	10,3
1GSL03M-L4C	12	Rp 1 1/4	369	603	3,9	11,2
1GSL05M-L4C	18	Rp 1 1/4	472	736	4,9	12,7
1GSL07M-L4C	24	Rp 1 1/4	578	862	5,8	14,2
1GSL11M-L4C	35	Rp 1 1/4	824	1153	8,7	19,6
1GSL15M-L4C	49	Rp 1 1/4	1068	1459	11,8	24,5
1GSL03T-L4C	12	Rp 1 1/4	369	583	3,9	10,9
1GSL05T-L4C	18	Rp 1 1/4	472	706	4,9	12,1
1GSL07T-L4C	24	Rp 1 1/4	578	842	5,8	13,6
1GSL11T-L4C	35	Rp 1 1/4	824	1108	8,7	17,1
1GSL15T-L4C	49	Rp 1 1/4	1068	1414	11,8	23,8

* Electric pumps exceeding 1500 mm in length are supplied uncoupled.
Motor and pump are packed separately.

1gsl-l4c-2p50-en_a_td

1GSL SERIES OPERATING CHARACTERISTICS AT 50 Hz

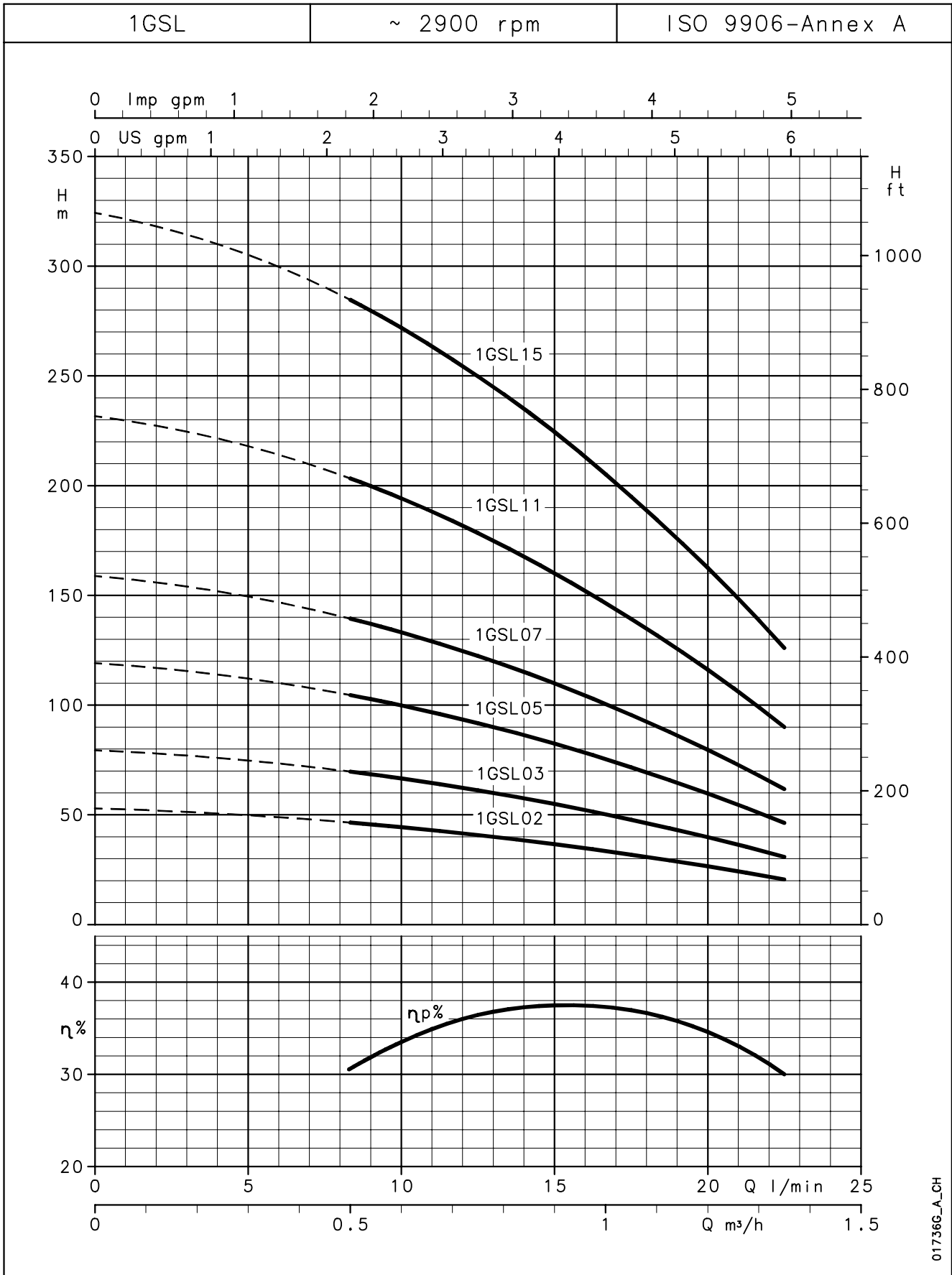

017366_A_CH

 These performances are valid for liquids with density $\rho = 1.0 \text{ Kg/dm}^3$ and kinematic viscosity $\nu = 1 \text{ mm}^2/\text{sec}$.

2GS SERIES OPERATING CHARACTERISTICS AT 50 Hz

PUMP TYPE	N. OF STAGES	MOTOR POWER		Q = DELIVERY						
				l/min	0	20	25	30	40	50
				m ³ /h	0	1,2	1,5	1,8	2,4	3
				H = TOTAL HEAD METRES COLUMN OF WATER						
2GS02 ⁽¹⁾	5	0,37	0,5	33	30	28	26	20	13	
2GS03	7	0,37	0,5	47	42	40	36	29	19	
2GS05	10	0,55	0,75	67	60	56	52	41	27	
2GS07	14	0,75	1	93	83	79	73	57	37	
2GS11	20	1,1	1,5	133	119	113	104	82	53	
2GS15	28	1,5	2	187	167	158	146	115	74	
2GS22	40	2,2	3	267	238	226	208	164	106	
2GS30	52	3	4	347	309	294	271	213	138	

(1) Maximum pump absorbed power: 0,25 kW - 0,33 HP.

2gs-2p50-en_c_th

2GS..4OS SERIES DIMENSIONS AND WEIGHTS

ELECTRO PUMP TYPE *	N. OF STAGES	DNM	DIMENSIONS (mm)		PUMP WEIGHT kg	ELECTRO PUMP WEIGHT kg
			L1	L		
			2GS02M-4OS	5		
2GS03M-4OS	7	Rp 1 1/4	280	633	2,9	10,5
2GS05M-4OS	10	Rp 1 1/4	332	685	3,5	11,7
2GS07M-4OS	14	Rp 1 1/4	402	780	4,2	13,5
2GS11M-4OS	20	Rp 1 1/4	507	920	5,3	16,5
2GS15M-4OS	28	Rp 1 1/4	680	1128	7,1	19,9
2GS22M-4OS	40	Rp 1 1/4	914	1412	10,1	25,2
2GS03T-4OS	7	Rp 1 1/4	280	612	2,9	10
2GS05T-4OS	10	Rp 1 1/4	332	685	3,5	11,1
2GS07T-4OS	14	Rp 1 1/4	402	755	4,2	12,4
2GS11T-4OS	20	Rp 1 1/4	507	885	5,3	14,6
2GS15T-4OS	28	Rp 1 1/4	680	1093	7,1	18,5
2GS22T-4OS	40	Rp 1 1/4	914	1362	10,1	23
2GS30T-4OS	52	Rp 1 1/4	1120	1568	12,2	26,1

2gs-4os-2p50-en_a_td

2GS..L4C SERIES DIMENSIONS AND WEIGHTS

ELECTRO PUMP TYPE *	N. OF STAGES	DNM	DIMENSIONS (mm)		PUMP WEIGHT kg	ELECTRO PUMP WEIGHT kg
			L1	L		
			2GS02M-L4C	5		
2GS03M-L4C	7	Rp 1 1/4	280	514	2,9	10,1
2GS05M-L4C	10	Rp 1 1/4	332	596	3,5	11,3
2GS07M-L4C	14	Rp 1 1/4	402	686	4,2	12,6
2GS11M-L4C	20	Rp 1 1/4	507	836	5,3	16,2
2GS15M-L4C	28	Rp 1 1/4	680	1071	7,1	19,8
2GS22M-L4C	40	Rp 1 1/4	914	1325	10,1	24,3
2GS03T-L4C	7	Rp 1 1/4	280	494	2,9	9,9
2GS05T-L4C	10	Rp 1 1/4	332	566	3,5	10,7
2GS07T-L4C	14	Rp 1 1/4	402	666	4,2	12
2GS11T-L4C	20	Rp 1 1/4	507	791	5,3	13,7
2GS15T-L4C	28	Rp 1 1/4	680	1026	7,1	19,1
2GS22T-L4C	40	Rp 1 1/4	914	1305	10,1	22,9
2GS30T-L4C	52	Rp 1 1/4	1120	1662	12,2	32,8

* Electric pumps exceeding 1500 mm in length are supplied uncoupled.
Motor and pump are packed separately.

2gs-l4c-2p50-en_a_td

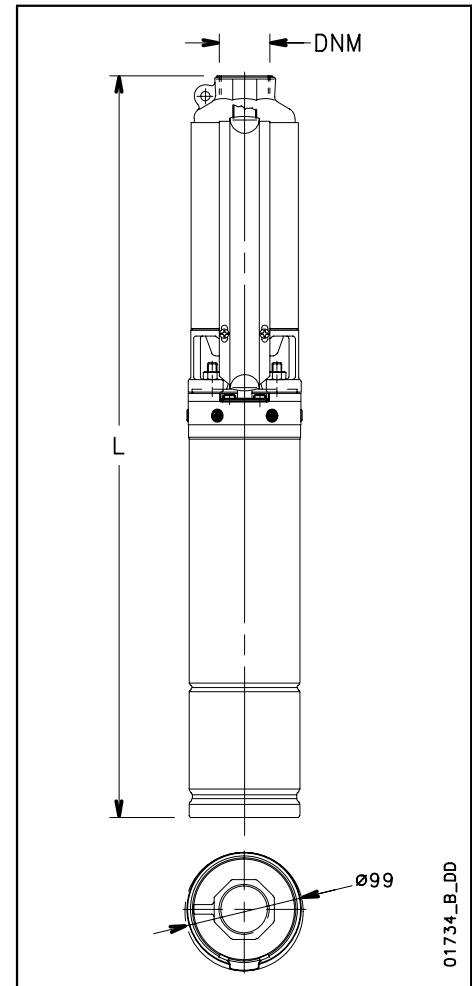
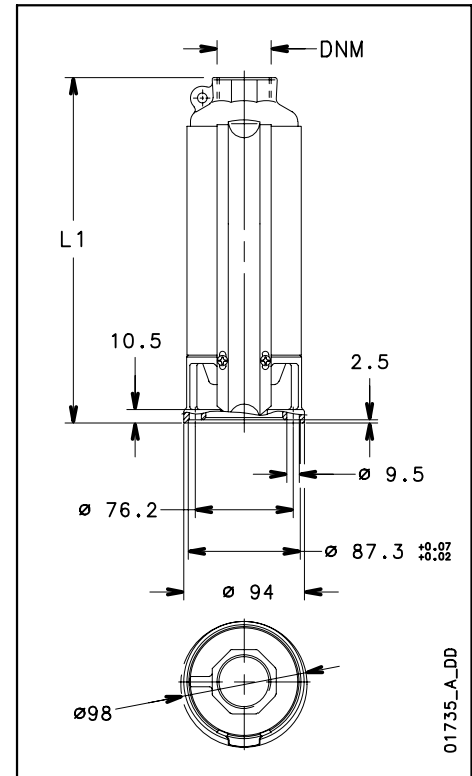

2GS SERIES OPERATING CHARACTERISTICS AT 50 Hz

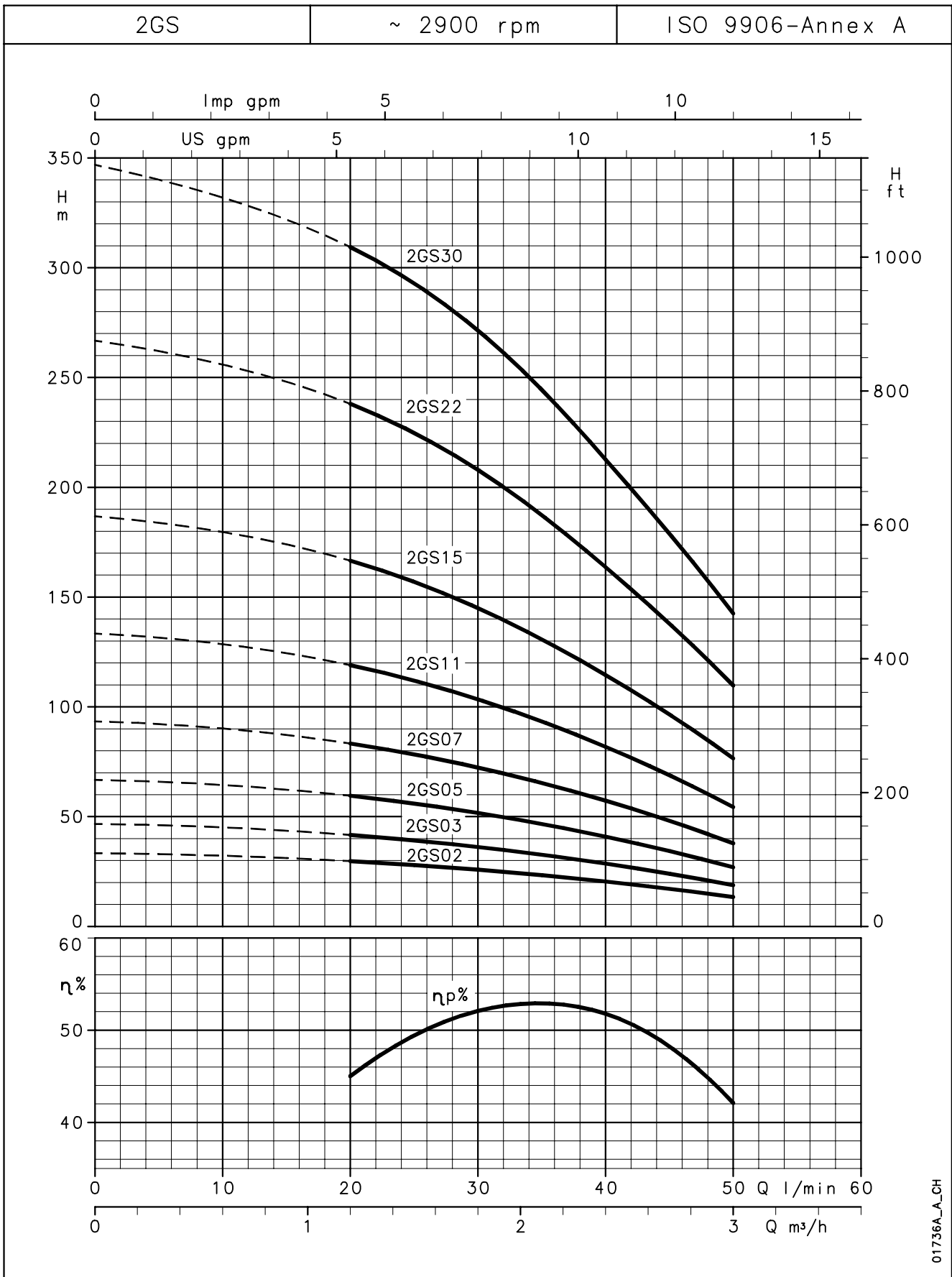

01736A_A-CH

4GS SERIES OPERATING CHARACTERISTICS AT 50 Hz

PUMP TYPE	N. OF STAGES	MOTOR POWER		Q = DELIVERY						
				l/min	0	30	40	60	80	90
				m ³ /h	0	1,8	2,4	3,6	4,8	5,4
				H = TOTAL HEAD METRES COLUMN OF WATER						
4GS03M	4	0,37	0,5	27	24	23	19	13	9	
4GS05M	7	0,55	0,75	47	42	40	33	22	15	
4GS07M	9	0,75	1	60	54	51	42	28	19	
4GS11M	14	1,1	1,5	94	84	80	66	44	30	
4GS15M	19	1,5	2	127	114	108	89	60	40	
4GS22M	27	2,2	3	181	162	154	127	85	57	
4GS30T	35	3	4	228	204	194	160	107	72	
4GS40T	48	4	5,5	321	288	274	226	151	102	

4gs-2p50-en_b_th

4GS..4OS SERIES DIMENSIONS AND WEIGHTS

ELECTRO PUMP TYPE *	N. OF STAGES	DNM	DIMENSIONS (mm)		PUMP WEIGHT kg	ELECTRO PUMP WEIGHT kg
			L1	L		
			4GS03M-4OS	4		
4GS05M-4OS	7	Rp 1 1/4	309	662	3,1	11,3
4GS07M-4OS	9	Rp 1 1/4	352	730	3,5	12,8
4GS11M-4OS	14	Rp 1 1/4	460	873	4,6	15,8
4GS15M-4OS	19	Rp 1 1/4	568	1016	5,7	18,5
4GS22M-4OS	27	Rp 1 1/4	770	1268	7,6	22,7
4GS03T-4OS	4	Rp 1 1/4	245	577	2,5	9,6
4GS05T-4OS	7	Rp 1 1/4	309	662	3,1	10,7
4GS07T-4OS	9	Rp 1 1/4	352	705	3,5	11,7
4GS11T-4OS	14	Rp 1 1/4	460	838	4,6	13,9
4GS15T-4OS	19	Rp 1 1/4	568	981	5,7	17,1
4GS22T-4OS	27	Rp 1 1/4	770	1218	7,6	20,5
4GS30T-4OS	35	Rp 1 1/4	967	1415	9,6	23,5
4GS40T-4OS	48	Rp 1 1/4	1248	1816	12,8	30,6

4gs-4os-2p50-en_a_td

4GS..L4C SERIES DIMENSIONS AND WEIGHTS

ELECTRO PUMP TYPE*	N. OF STAGES	DNM	DIMENSIONS (mm)		PUMP WEIGHT kg	ELECTRO PUMP WEIGHT kg
			L1	L		
			4GS03M-L4C	4		
4GS05M-L4C	7	Rp 1 1/4	309	573	3,1	10,9
4GS07M-L4C	9	Rp 1 1/4	352	636	3,5	11,9
4GS11M-L4C	14	Rp 1 1/4	460	789	4,6	15,5
4GS15M-L4C	19	Rp 1 1/4	568	959	5,7	18,4
4GS22M-L4C	27	Rp 1 1/4	770	1181	7,6	21,8
4GS03T-L4C	4	Rp 1 1/4	245	459	2,5	9,5
4GS05T-L4C	7	Rp 1 1/4	309	543	3,1	10,3
4GS07T-L4C	9	Rp 1 1/4	352	616	3,5	11,3
4GS11T-L4C	14	Rp 1 1/4	460	744	4,6	13
4GS15T-L4C	19	Rp 1 1/4	568	914	5,7	17,7
4GS22T-L4C	27	Rp 1 1/4	770	1161	7,6	20,4
4GS30T-L4C	35	Rp 1 1/4	967	1509	9,6	30,2
4GS40T-L4C	48	Rp 1 1/4	1248	1860	12,8	36,5

* Electric pumps exceeding 1500 mm in length are supplied uncoupled.
Motor and pump are packed separately.

4gs-l4c-2p50-en_a_td

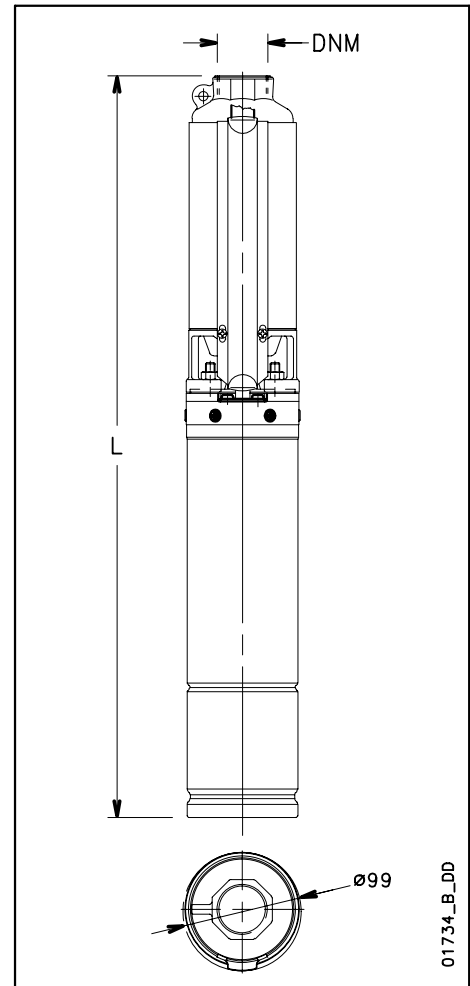
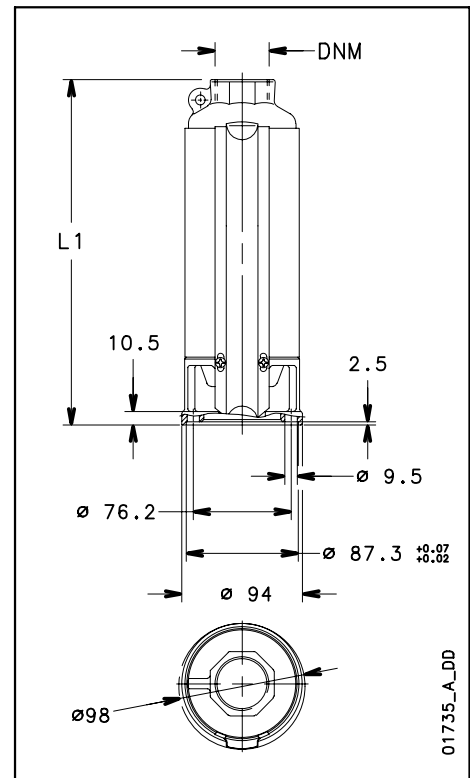

**4GS SERIES
OPERATING CHARACTERISTICS AT 50 Hz**

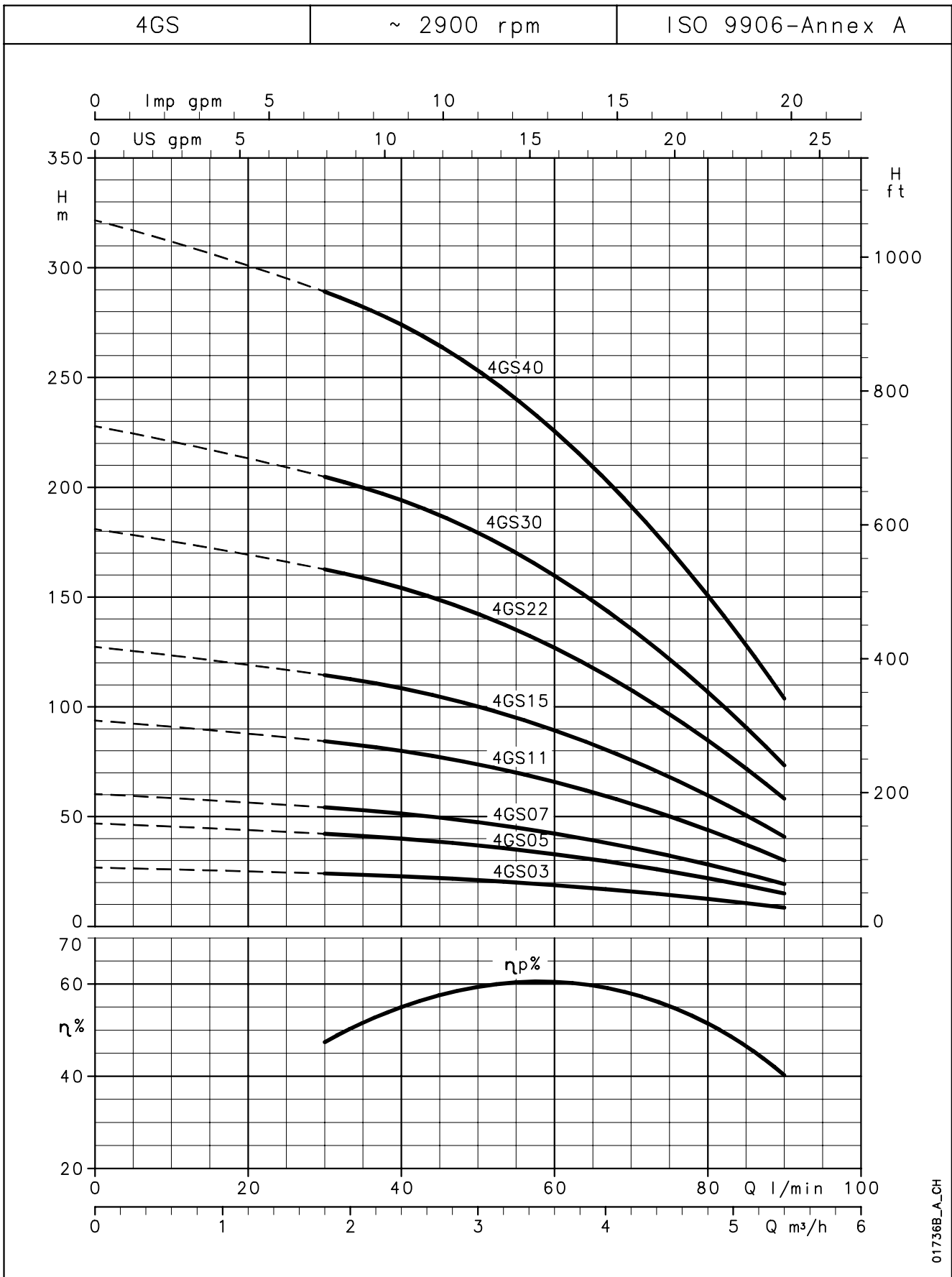

017368_A_CH

These performances are valid for liquids with density $\rho = 1.0 \text{ Kg/dm}^3$ and kinematic viscosity $\nu = 1 \text{ mm}^2/\text{sec}$.

6GS SERIES OPERATING CHARACTERISTICS AT 50 Hz

PUMP TYPE	N. OF STAGES	MOTOR POWER		Q = DELIVERY								
				V/min 0	46,67	70,00	90,00	110,00	130,00	140,00		
				m ³ /h 0	2,8	4,2	5,4	6,6	7,8	8,4		
		kW		HP		H = TOTAL HEAD METRES COLUMN OF WATER						
6GS05	5	0,55	0,75	30,6	27,0	24,6	21,6	17,7	12,8	9,9		
6GS07	7	0,75	1	42,8	37,8	34,4	30,3	24,8	17,9	13,8		
6GS11	10	1,1	1,5	61,9	54,3	49,6	43,9	36,1	26,4	20,7		
6GS15	14	1,5	2	86,7	76,1	69,5	61,4	50,6	36,9	29,0		
6GS22	21	2,2	3	132,0	117,5	107,9	95,6	78,7	57,1	44,8		
6GS30	29	3	4	182,5	162,4	149,2	132,2	108,8	79,0	62,0		
6GS40R	33	4	5,5	211,0	187,8	172,5	152,8	125,8	91,3	71,7		
6GS40	38	4	5,5	243,0	216,3	198,7	176,0	144,8	105,2	82,5		
6GS55R	44	5,5	7,5	281,4	250,4	230,1	203,8	167,7	121,8	95,6		
6GS55	52	5,5	7,5	332,6	296,0	271,9	240,8	198,2	143,9	112,9		

Hydraulic performances in compliance with ISO 9906:2012 - Grade 3B (ex ISO 9906:1999 - Annex A)

6gs-2p50-en_d_th

6GS..40S SERIES DIMENSIONS AND WEIGHTS

ELECTRO PUMP TYPE*	N. OF STAGES	DNM	DIMENSIONS (mm)		PUMP WEIGHT kg	ELECTRO PUMP WEIGHT kg
			L1	L		
6GS05M-40S	5	Rp 1 1/4	329	682	3,5	11,7
6GS07M-40S	7	Rp 1 1/4	390	768	4,2	13,5
6GS11M-40S	10	Rp 1 1/4	485	898	5,1	16,3
6GS15M-40S	14	Rp 1 1/4	645	1093	6,8	19,6
6GS22M-40S	21	Rp 1 1/4	862	1360	9,1	24,2
6GS05T-40S	5	Rp 1 1/4	329	682	3,5	11,1
6GS07T-40S	7	Rp 1 1/4	390	743	4,2	12,4
6GS11T-40S	10	Rp 1 1/4	485	863	5,1	14,4
6GS15T-40S	14	Rp 1 1/4	645	1058	6,8	18,2
6GS22T-40S	21	Rp 1 1/4	862	1310	9,1	22
6GS30T-40S	29	Rp 1 1/4	1127	1575	11,8	25,7
6GS40RT-40S	33	Rp 1 1/4	1252	1822	13,2	30,5
6GS40T-40S	38	Rp 1 1/4	1406	1974	14,7	32,5
6GS55RT-40S	44	Rp 1 1/4	1593	2223	16,6	37,4
6GS55T-40S	52	Rp 1 1/4	1840	2468	19,3	40,6

6gs-40s-2p50-en_b_td

6GS..L4C SERIES DIMENSIONS AND WEIGHTS

ELECTRO PUMP TYPE*	N. OF STAGES	DNM	DIMENSIONS (mm)		PUMP WEIGHT kg	ELECTRO PUMP WEIGHT kg
			L1	L		
6GS05M-L4C	5	Rp 1 1/4	329	593	3,5	11,3
6GS07M-L4C	7	Rp 1 1/4	390	674	4,2	12,6
6GS11M-L4C	10	Rp 1 1/4	485	814	5,1	16
6GS15M-L4C	14	Rp 1 1/4	645	1036	6,8	19,5
6GS22M-L4C	21	Rp 1 1/4	862	1273	9,1	23,3
6GS05T-L4C	5	Rp 1 1/4	329	563	3,5	10,7
6GS07T-L4C	7	Rp 1 1/4	390	654	4,2	12
6GS11T-L4C	10	Rp 1 1/4	485	769	5,1	13,5
6GS15T-L4C	14	Rp 1 1/4	645	991	6,8	18,8
6GS22T-L4C	21	Rp 1 1/4	862	1253	9,1	21,9
6GS30T-L4C	29	Rp 1 1/4	1127	1669	11,8	32,4
6GS40RT-L4C	33	Rp 1 1/4	1252	1822	13,2	36,7
6GS40T-L4C	38	Rp 1 1/4	1406	1974	14,7	38,4
6GS55RT-L4C	44	Rp 1 1/4	1593	2223	16,6	43,4
6GS55T-L4C	52	Rp 1 1/4	1840	2522	19,3	46,3

* Electric pumps exceeding 1500 mm in length are supplied uncoupled.
Motor and pump are packed separately.

6gs-l4c-2p50-en_b_td

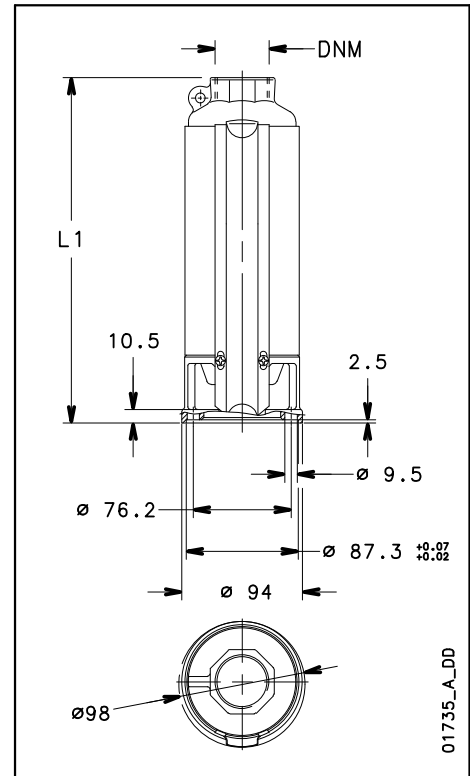

01735_A_DD

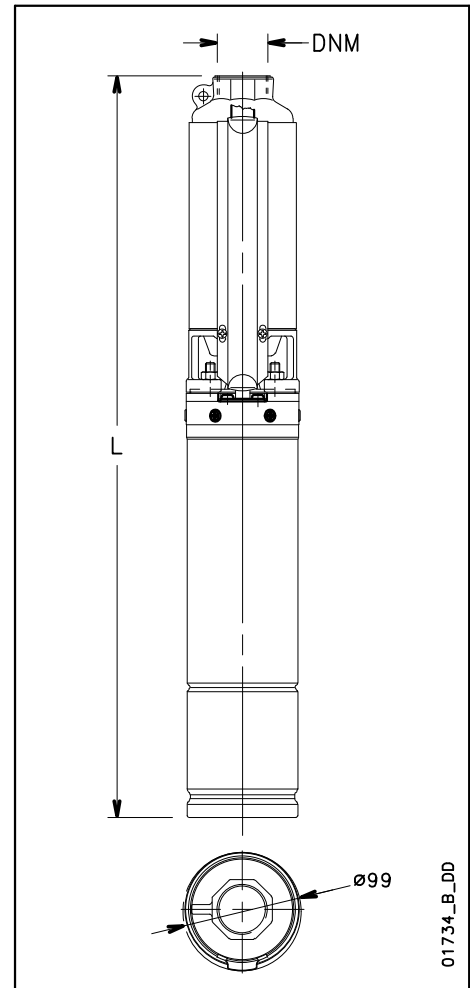

01734_B_DD

**6GS SERIES
OPERATING CHARACTERISTICS AT 50 Hz**

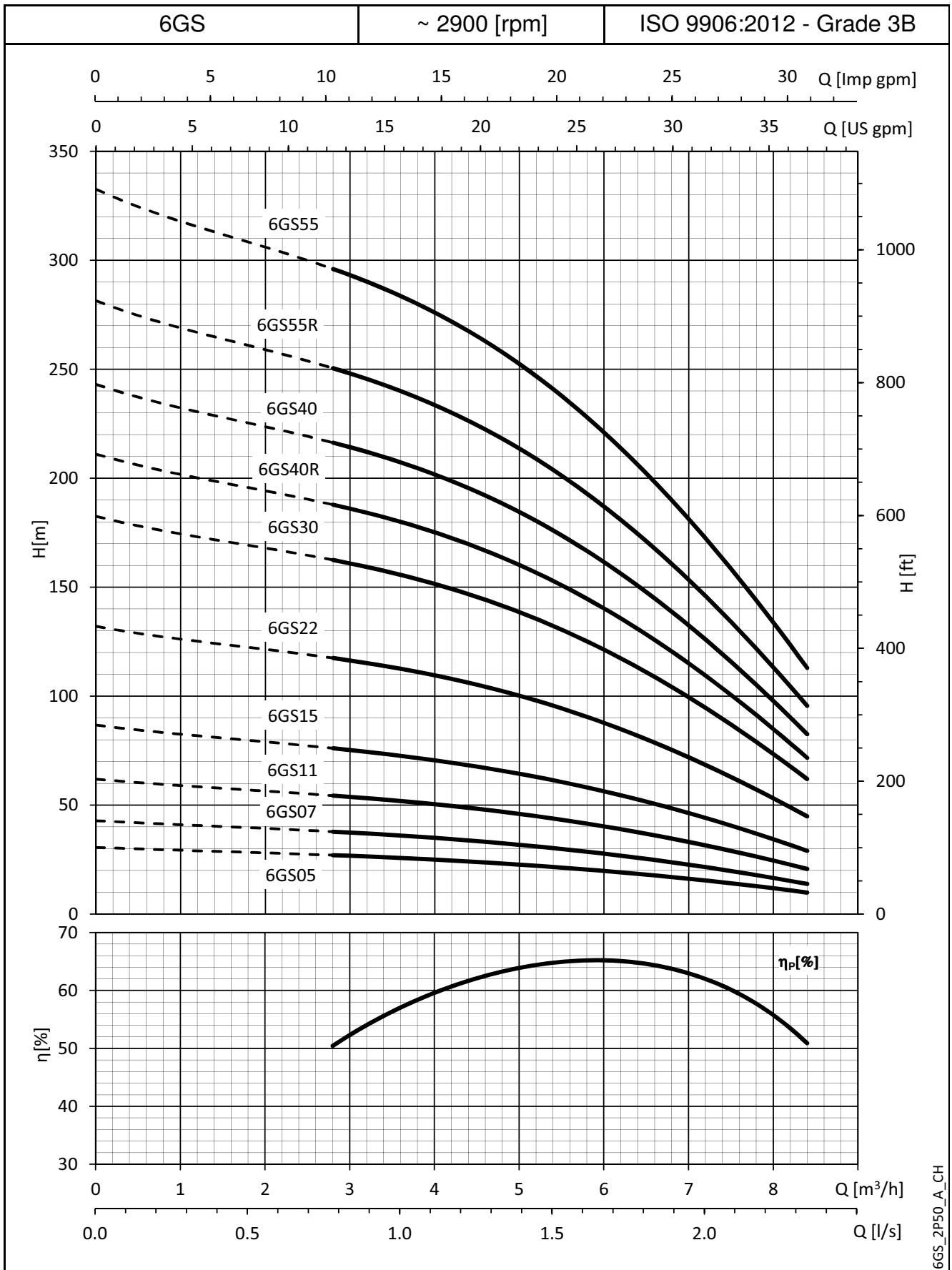

6GS_2P50_A_CH

These performances are valid for liquids with density $\rho = 1.0 \text{ Kg/dm}^3$ and kinematic viscosity $\nu = 1 \text{ mm}^2/\text{sec}$.

8GS SERIES OPERATING CHARACTERISTICS AT 50 Hz

PUMP TYPE	N. OF STAGES	MOTOR POWER		Q = DELIVERY						
				l/min	58,33	90,00	120,00	140,00	160,00	183,33
				m^3/h	3,5	5,4	7,2	8,4	9,6	11,0
		kW	HP	H = TOTAL HEAD METRES COLUMN OF WATER						
8GS07	5			0,75	1	32,9	29,1	26,6	22,9	19,5
8GS11	7	1,1	1,5	46,0	40,7	37,2	32,0	27,3	21,4	13,1
8GS15	10	1,5	2	65,8	58,2	53,1	45,7	39,0	30,6	18,7
8GS22	15	2,2	3	99,0	88,4	81,2	70,2	60,0	47,4	30,1
8GS30	21	3	4	138,0	123,2	113,2	97,8	83,6	66,1	42,0
8GS40	28	4	5,5	188,9	168,7	154,9	133,9	114,4	90,5	57,5
8GS55R	33	5,5	7,5	224,3	201,9	186,6	162,8	140,0	110,5	67,0
8GS55	38	5,5	7,5	258,3	232,4	214,8	187,5	161,2	127,3	77,2
8GS75R	44	7,5	10	299,1	269,1	248,7	217,1	186,6	147,4	89,4
8GS75	50	7,5	10	339,9	305,8	282,7	246,7	212,1	167,5	101,6

Hydraulic performances in compliance with ISO 9906:2012 - Grade 3B (ex ISO 9906:1999 - Annex A)

8gs-2p50-en_e_th

8GS..4OS SERIES DIMENSIONS AND WEIGHTS

ELECTRO PUMP TYPE*	N. OF STAGES	DNM	DIMENSIONS (mm)		PUMP WEIGHT kg	ELECTRO PUMP WEIGHT kg
			L1	L		
8GS07M-4OS	5	Rp 2	330	708	3,5	12,5
8GS11M-4OS	7	Rp 2	392	805	4,2	15
8GS15M-4OS	10	Rp 2	485	933	5,1	17,5
8GS22M-4OS	15	Rp 2	642	1140	7,1	21,8
8GS07T-4OS	5	Rp 2	330	683	3,5	11,3
8GS11T-4OS	7	Rp 2	392	770	4,2	13,2
8GS15T-4OS	10	Rp 2	485	898	5,1	16
8GS22T-4OS	15	Rp 2	642	1090	7,1	19,5
8GS30T-4OS	21	Rp 2	864	1312	9,1	22,5
8GS40T-4OS	28	Rp 2	1081	1649	11,5	29
8GS55RT-4OS	33	Rp 2	1254	1884	13,3	34,3
8GS55T-4OS	38	Rp 2	1410	2038	14,7	35,5
8GS75RT-4OS	44	Rp 2	1594	2223	16,6	45,2
8GS75T-4OS	50	Rp 2	1780	2614	19,1	47,5

8gs-4os-2p50-en_b_td

8GS..L4C SERIES DIMENSIONS AND WEIGHTS

ELECTRO PUMP TYPE*	N. OF STAGES	DNM	DIMENSIONS (mm)		PUMP WEIGHT kg	ELECTRO PUMP WEIGHT kg
			L1	L		
8GS07M-L4C	5	Rp 2	330	614	3,5	11,7
8GS11M-L4C	7	Rp 2	392	721	4,2	14,9
8GS15M-L4C	10	Rp 2	485	876	5,1	17,6
8GS22M-L4C	15	Rp 2	642	1053	7,1	21,1
8GS07T-L4C	5	Rp 2	330	594	3,5	11,1
8GS11T-L4C	7	Rp 2	392	676	4,2	12,4
8GS15T-L4C	10	Rp 2	485	831	5,1	16,9
8GS22T-L4C	15	Rp 2	642	1033	7,1	19,7
8GS30T-L4C	21	Rp 2	864	1406	9,1	29,5
8GS40T-L4C	28	Rp 2	1081	1693	11,5	35
8GS55RT-L4C	33	Rp 2	1254	1938	13,3	40,1
8GS55T-L4C	38	Rp 2	1410	2092	14,7	41,5
8GS75RT-L4C	44	Rp2	1594	2358	16,6	45,6
8GS75T-L4C	50	Rp 2	1780	2542	19,1	48,1

* Electric pumps exceeding 1500 mm in length are supplied uncoupled.
Motor and pump are packed separately.

8gs-l4c-2p50-en_b_td

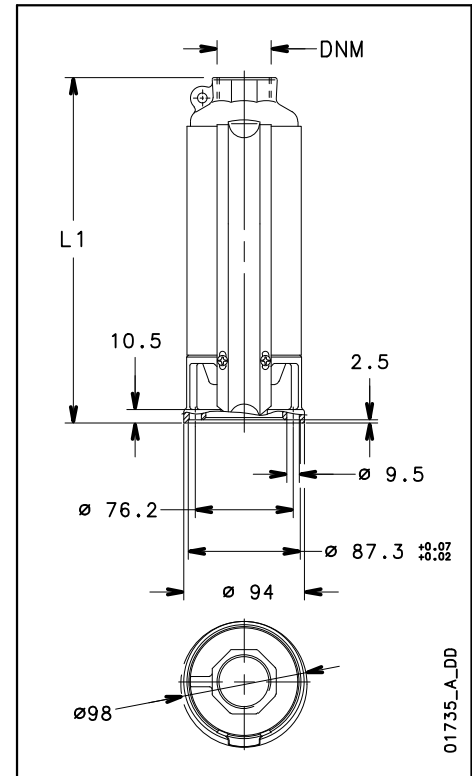

01735_A_DD

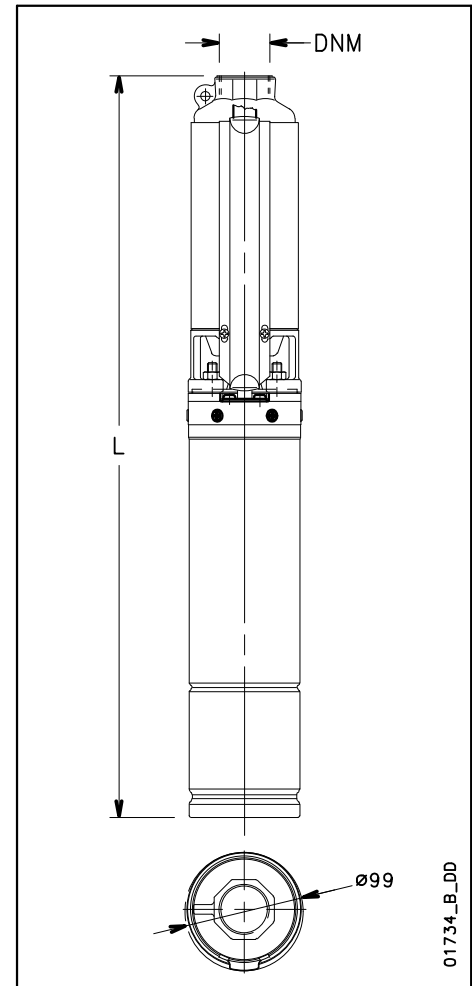

01734_B_DD

**8GS SERIES
OPERATING CHARACTERISTICS AT 50 Hz**

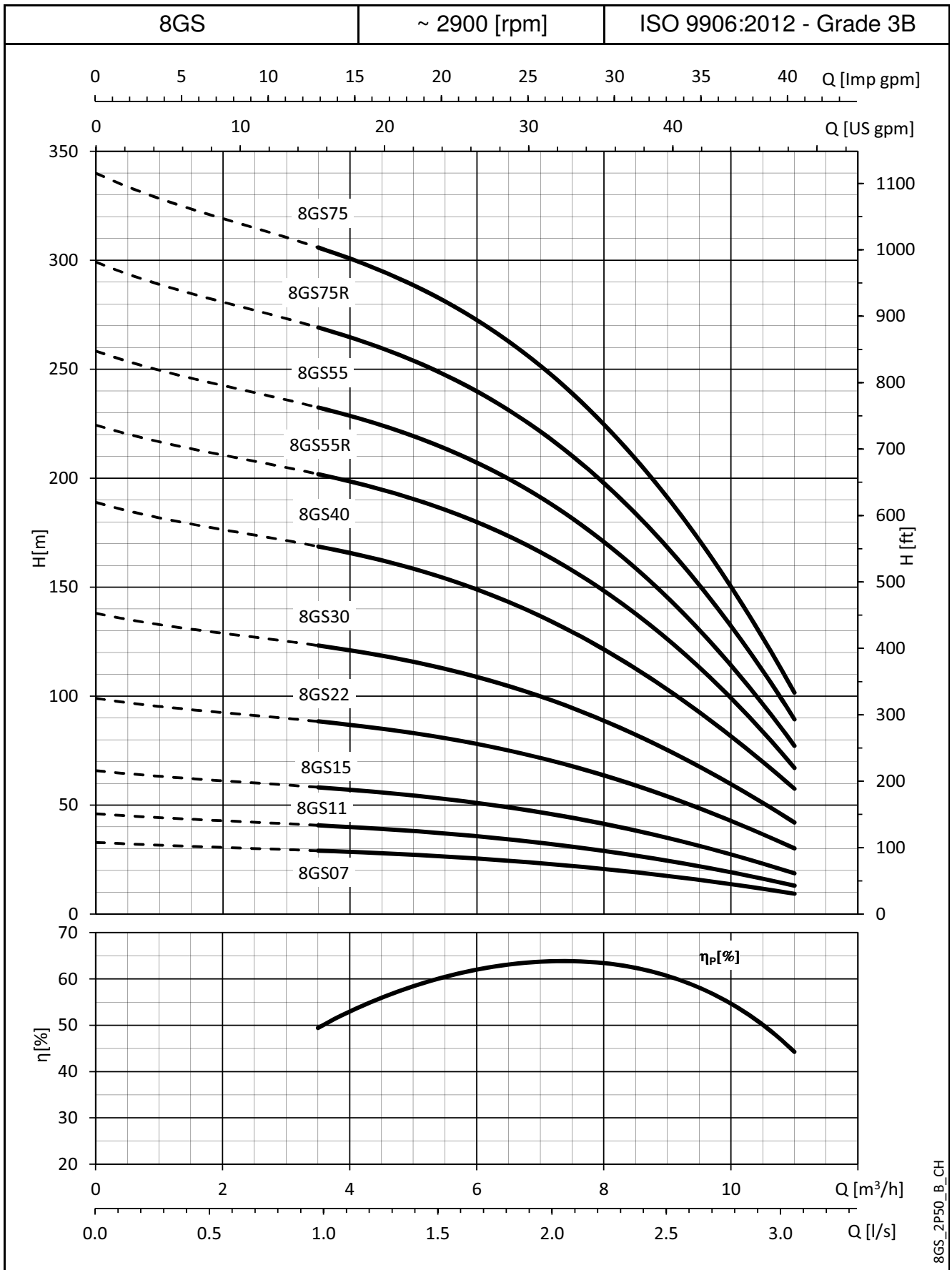

8GS_2P50_B_CH

These performances are valid for liquids with density $\rho = 1.0 \text{ Kg/dm}^3$ and kinematic viscosity $\nu = 1 \text{ mm}^2/\text{sec}$.

12GS SERIES OPERATING CHARACTERISTICS AT 50 Hz

PUMP TYPE	N. OF STAGES	MOTOR POWER		Q = DELIVERY						
				l/min 0	100	150	175	200	225	250
				m ³ /h 0	6,0	9,0	10,5	12,0	13,5	15,0
kW		HP	H = TOTAL HEAD METRES COLUMN OF WATER							
12GS11	7	1,1	1,5	36,6	31,2	26,1	22,7	18,6	13,9	8,5
12GS15	10	1,5	2	52,3	44,5	37,3	32,4	26,6	19,8	12,1
12GS22	14	2,2	3	75,9	66,9	58,2	52,1	44,8	36,5	27,2
12GS30	19	3	4	102,4	90,0	78,8	71,0	61,5	50,3	37,6
12GS40	25	4	5,5	135,5	119,5	103,9	93,1	80,1	65,1	48,5
12GS55R	30	5,5	7,5	161,7	142,1	124,4	112,0	97,0	79,4	59,3
12GS55	35	5,5	7,5	188,7	165,8	145,2	130,7	113,2	92,7	69,2
12GS75	43	7,5	10	231,8	203,7	178,4	160,6	139,1	113,8	85,1

Hydraulic performances in compliance with ISO 9906:2012 - Grade 3B (ex ISO 9906:1999 - Annex A)

12gs-2p50-en_c_th

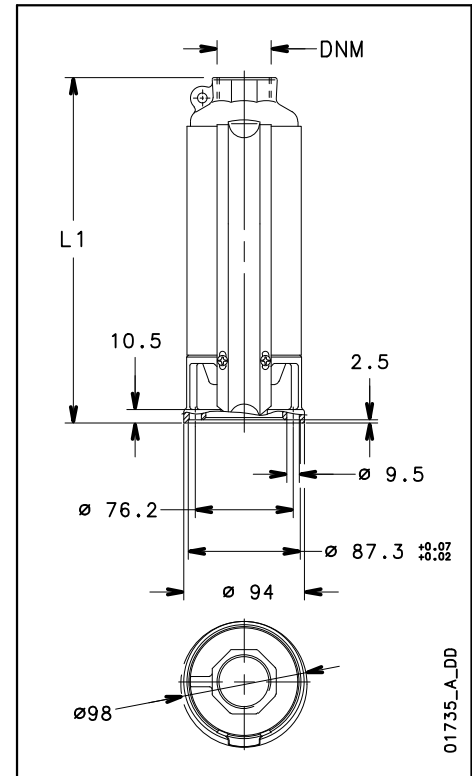

12GS..4OS SERIES DIMENSIONS AND WEIGHTS

ELECTRO PUMP TYPE*	N. OF STAGES	DNM	DIMENSIONS (mm)		PUMP WEIGHT kg	ELECTRO PUMP WEIGHT kg
			L1	L		
12GS11M/B-4OS	7	Rp 2	539	954	5,2	15,9
12GS15M/B-4OS	10	Rp 2	695	1145	7	19,3
12GS22M/B-4OS	14	Rp 2	940	1440	9,3	23,9
12GS15T/B-4OS	10	Rp 2	695	1110	7	17,9
12GS22T/B-4OS	14	Rp 2	940	1390	9,3	20,3
12GS30T/B-4OS	19	Rp 2	1200	1650	12	25,4
12GS40T/B-4OS	25	Rp 2	1529	2149	15,5	32,8
12GS55RT/B-4OS	30	Rp 2	1789	2419	17,7	38,5
12GS55T/B-4OS	35	Rp 2	2048	2678	21,1	41,9
12GS75T/B-4OS	43	Rp 2	2464	3300	26,3	54,6

12gs-4os-2p50-en_b_td

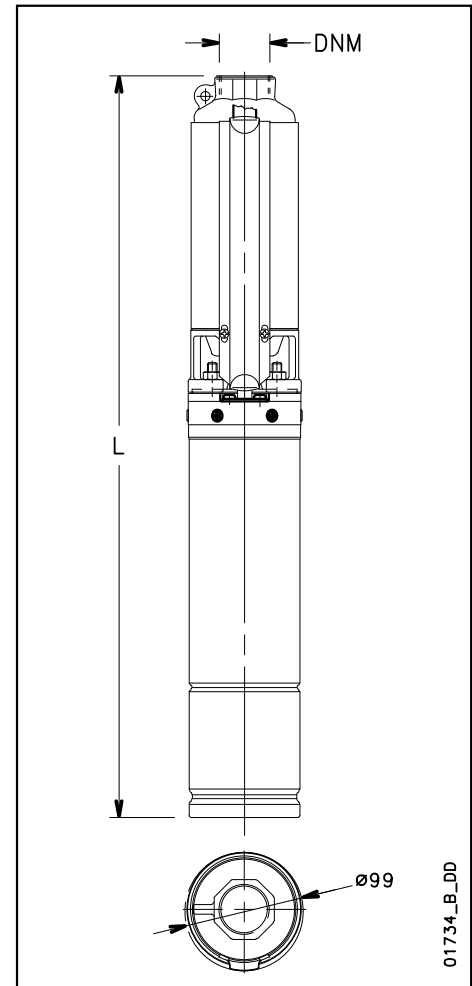

12GS..L4C SERIES DIMENSIONS AND WEIGHTS

ELECTRO PUMP TYPE*	N. OF STAGES	DNM	DIMENSIONS (mm)		PUMP WEIGHT kg	ELECTRO PUMP WEIGHT kg
			L1	L		
12GS11M/B-L4C	7	Rp 2	539	868	5,2	15,9
12GS15M/B-L4C	10	Rp 2	695	1086	7	19,5
12GS22M/B-L4C	14	Rp 2	940	1351	9,3	23,3
12GS15T/B-L4C	10	Rp 2	695	1041	7	18,8
12GS22T/B-L4C	14	Rp 2	940	1331	9,3	21,9
12GS30T/B-L4C	19	Rp 2	1200	1742	12	30,6
12GS40T/B-L4C	25	Rp 2	1529	2141	15,5	39
12GS55RT/B-L4C	30	Rp 2	1789	2471	17,7	44,5
12GS55T/B-L4C	35	Rp 2	2048	2730	21,1	47,9
12GS75T/B-L4C	43	Rp 2	2464	3226	26,3	55,3

12gs-L4c-2p50-en_b_td

**12GS SERIES
OPERATING CHARACTERISTICS AT 50 Hz**

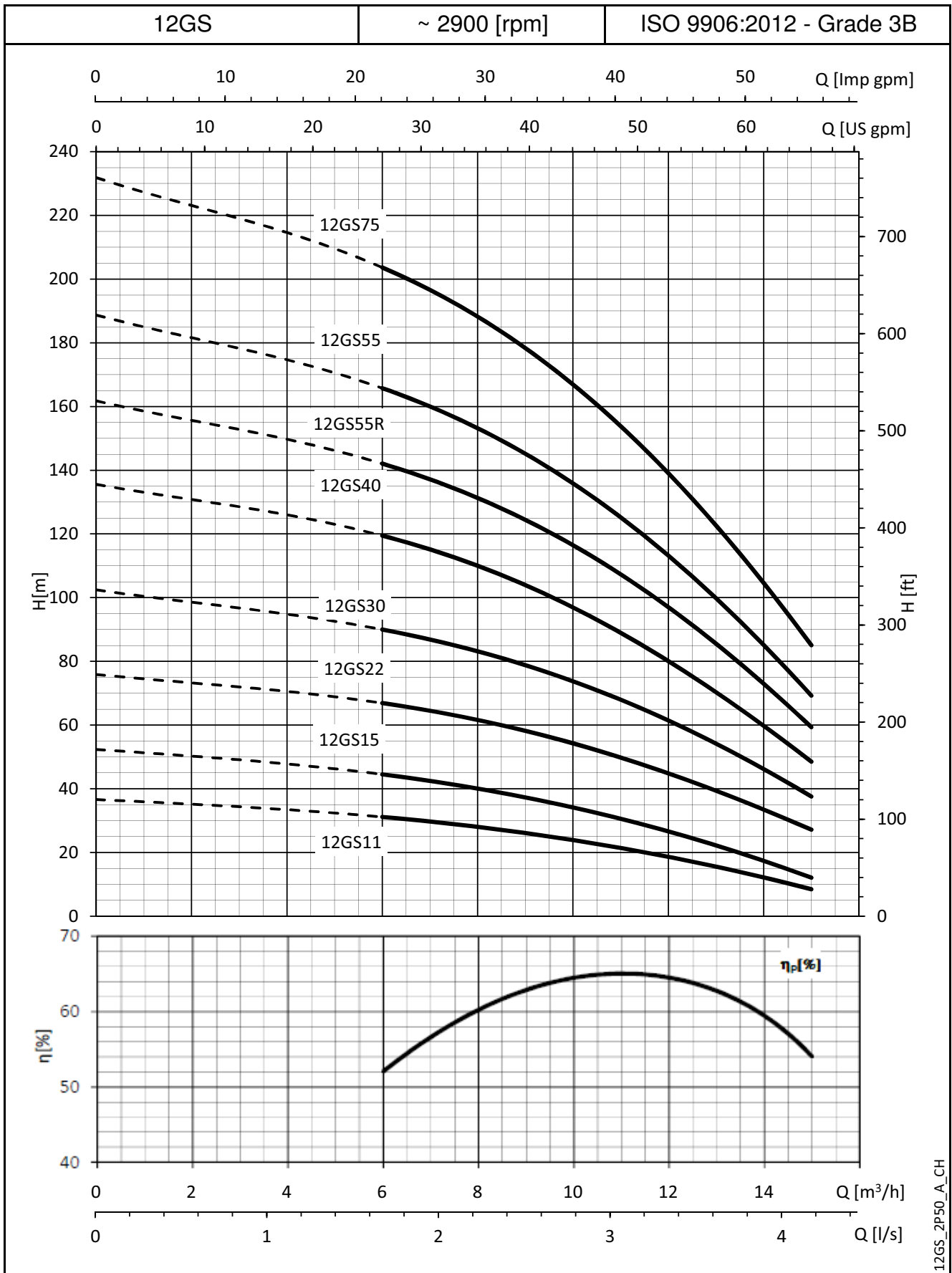

12GS_2P50_A_CH

These performances are valid for liquids with density $\rho = 1.0 \text{ Kg/dm}^3$ and kinematic viscosity $\nu = 1 \text{ mm}^2/\text{sec}$.

16GS SERIES OPERATING CHARACTERISTICS AT 50 Hz

PUMP TYPE	N. OF STAGES	MOTOR POWER		Q = DELIVERY						
				l/min 0	133.33	180.00	226.67	273.33	320.00	366.67
				m ³ /h 0	8.0	10.8	13.6	16.4	19.2	22.0
		kW	HP	H = TOTAL HEAD METRES COLUMN OF WATER						
16GS15	8			1.5	2	38.0	33.2	29.8	25.6	20.7
16GS22	12	2.2	3	56.9	49.8	44.7	38.3	31.0	22.8	13.9
16GS30	16	3	4	75.6	65.7	59.0	51.0	41.9	31.7	20.3
16GS40	21	4	5.5	98.0	83.8	74.7	64.4	53.1	40.3	25.3
16GS55R	25	5.5	7.5	120.0	104.3	93.7	81.0	66.6	50.3	32.2
16GS55	29	5.5	7.5	142.0	123.4	110.8	95.9	78.8	59.6	38.1

Hydraulic performances in compliance with ISO 9906:2012 - Grade 3B (ex ISO 9906:1999 - Annex A) 16gs-2p50-en_c_th

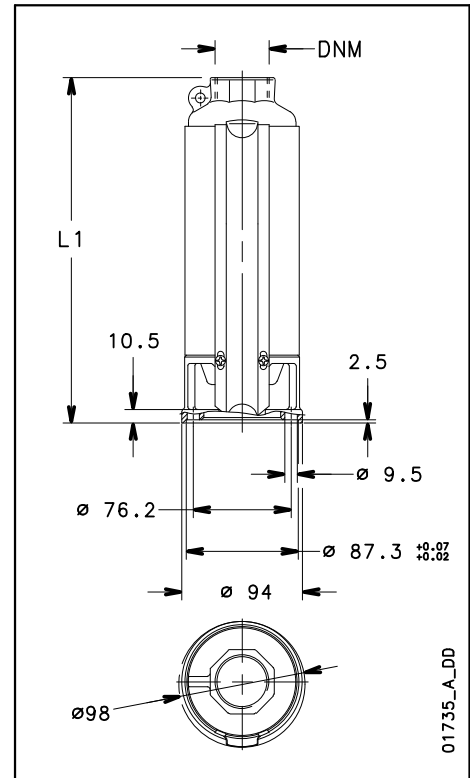

16GS..4OS SERIES DIMENSIONS AND WEIGHTS

ELECTRO PUMP TYPE*	N. OF STAGES	DNM	DIMENSIONS (mm)		PUMP WEIGHT kg	ELECTRO PUMP WEIGHT kg
			L1	L		
16GS15M-4OS	8	Rp 2	682	1132	7	19,3
16GS15T-4OS	8	Rp 2	682	1097	7	17,9
16GS22M-4OS	12	Rp 2	953	1451	9,7	24,3
16GS22T-4OS	12	Rp 2	953	1401	9,7	22,1
16GS30T-4OS	16	Rp 2	1224	1672	12,4	25,8
16GS40T-4OS	21	Rp 2	1621	2189	16,5	33,8
16GS55RT-4OS	25	Rp 2	1891	2519	19,1	39,9
16GS55T-4OS	29	Rp 2	2164	2792	21,9	42,7

16gs-4os-2p50-en_b_td

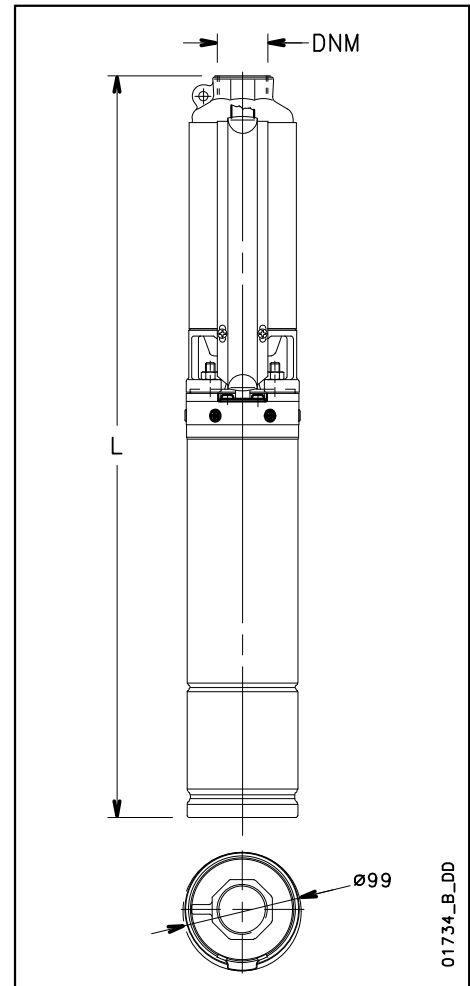

16GS..L4C SERIES DIMENSIONS AND WEIGHTS

ELECTRO PUMP TYPE*	N. OF STAGES	DNM	DIMENSIONS (mm)		PUMP WEIGHT kg	ELECTRO PUMP WEIGHT kg
			L1	L		
16GS15M-L4C	8	Rp 2	682	1075	7	19,5
16GS15T-L4C	8	Rp 2	682	1030	7	18,8
16GS22M-L4C	12	Rp 2	953	1364	9,7	23,7
16GS22T-L4C	12	Rp 2	953	1344	9,7	22,3
16GS30T-L4C	16	Rp 2	1224	1766	12,4	32,8
16GS40T-L4C	21	Rp 2	1621	2233	16,5	40
16GS55RT-L4C	25	Rp 2	1891	2573	19,1	45,9
16GS55T-L4C	29	Rp 2	2164	2846	21,9	48,7

16gs-l4c-2p50-en_b_td

**16GS SERIES
OPERATING CHARACTERISTICS AT 50 Hz**

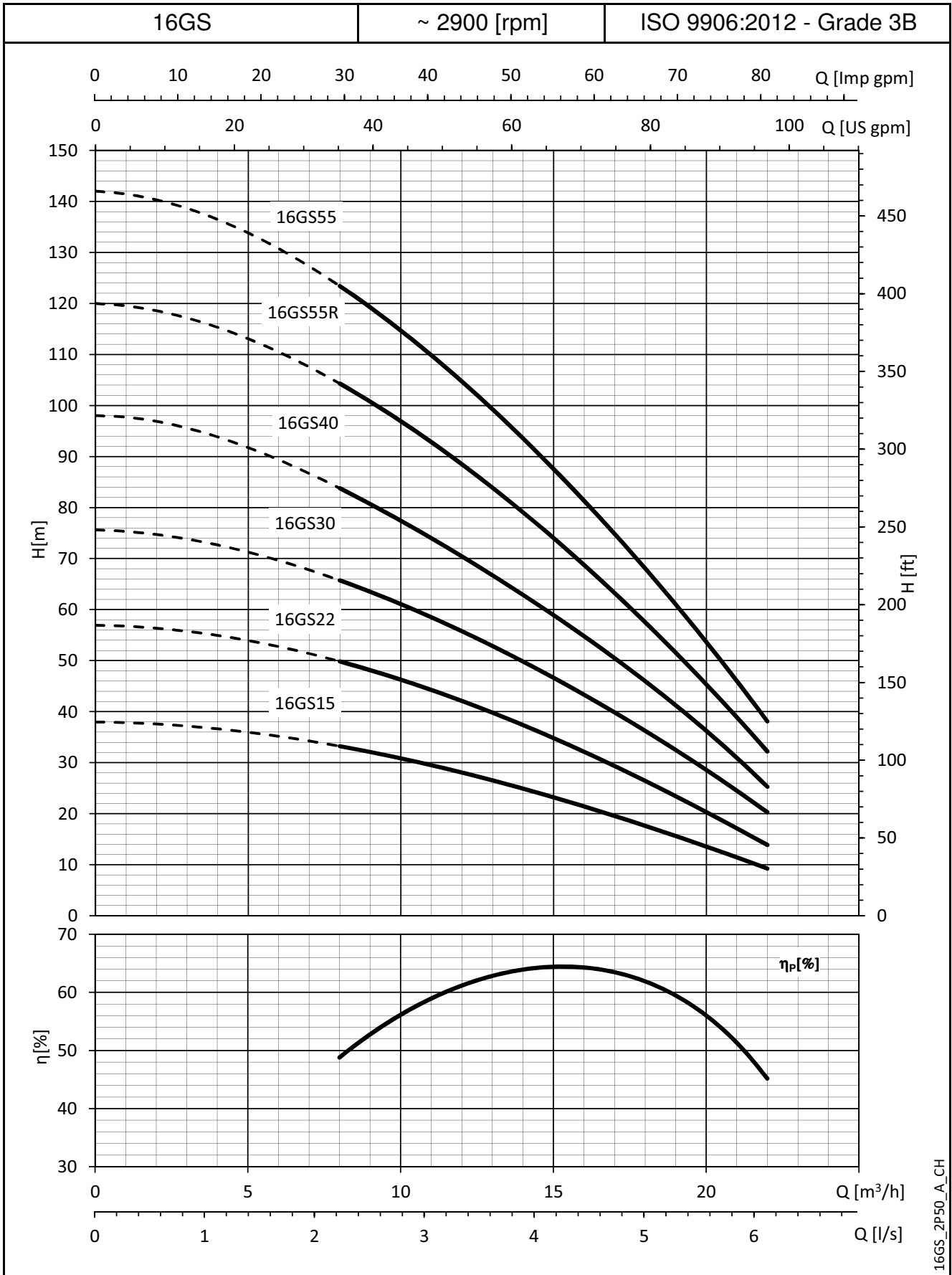

16GS_2P50_A_CH

These performances are valid for liquids with density $\rho = 1.0 \text{ Kg/dm}^3$ and kinematic viscosity $\nu = 1 \text{ mm}^2/\text{sec}$.

Xylem |'zīləm|

- 1) The tissue in plants that brings water upward from the roots;
- 2) a leading global water technology company.

We're a global team unified in a common purpose: creating innovative solutions to meet our world's water needs. Developing new technologies that will improve the way water is used, conserved, and re-used in the future is central to our work. We move, treat, analyze, and return water to the environment, and we help people use water efficiently, in their homes, buildings, factories and farms. In more than 150 countries, we have strong, long-standing relationships with customers who know us for our powerful combination of leading product brands and applications expertise, backed by a legacy of innovation.

For more information on how Xylem can help you, go to www.xyleminc.com



Legal head office
Xylem Water Solutions Italia Srl

Via Gioacchino Rossini 1/A
20020 - Lainate (MI) - Italy
Tel. (+39) 02 90358.1
Fax (+39) 02 9019990
www.xylemwatersolutions.com

For information and technical support
Xylem Service Italia Srl

Via Dottor Vittorio Lombardi 14
36075 - Montecchio Maggiore (VI) - Italy
Tel. (+39) 0444 707111
Fax (+39) 0444 491043
www.lowara.com

Lowara, HYDROVAR, Xylect are trademarks or registered trademarks of Xylem Inc. or one of its subsidiaries.
All other trademarks or registered trademarks are property of their respective owners.

Xylem Water Solutions Italia Srl reserves the right to make modification without prior notice.
Lowara, Xylem are trademarks of Xylem Inc. or one of its subsidiaries. © 2015 Xylem, Inc.

cod. 191005641 - P07/15