

Twin impeller centrifugal pumps with hydraulic parts manufactured from cast iron, suitable for irrigation and non-aggressive fluids for civil and industrial uses.



SPECIFICATIONS

- * Maximum working pressure: 6 bar for CB 80-100
10 bar for other models
- * Maximum liquid temperature:
35°C according EN 60335-2-41 for domestic uses
40°C for CB 80-100
90°C for other models

MATERIALS

- * Pump body in cast iron
- * Mechanical seal in carbon/ceramic/NBR
- * Impeller:
 - in tecnopolymer for CB 80-100
 - in brass for the other models
- * Shaft:
 - in AISI 303 for CB 150-200-300
 - in AISI 304 for CB 400-550
 - in AISI 416 for the other models

- * Bracket:
 - in alluminium for CB 80-100
 - in cast iron for the other models
- * Casing cover:- in AISI 304 for CB 80-100
- in cast iron for the other models

TECHNICAL DATA

- * T.E.F.C. 2 poles motor
- * Insulation class F
- * Protection degree IP44 (IP55 on request)
- * 1~230V ± 10% 50Hz, 3~230/400V ± 10% 50Hz
- * Permanent split capacitor and automatic thermal overload protection for single-phase version
- * Thermal protection to be provided by the user for three-phase version

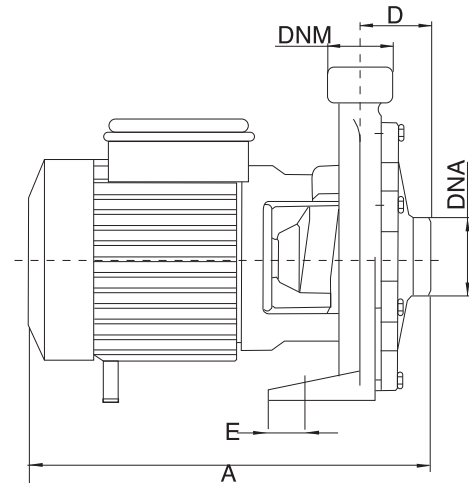
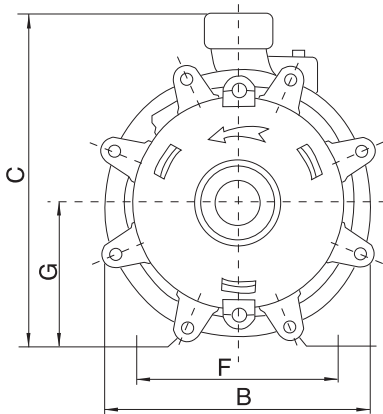

DIMENSIONAL TABLE

TYPE	DIMENSION IN mm.							SUCTION	DISCHARGE	Weight Kg
	A	B	C	D	E	F	G	DNA	DNM	
CB/80	345	190	235	67	14	156	96.5	1 1/4"	1"	14
CB/100	345	190	235	67	14	156	96.5	1 1/4"	1"	15
CB/150	345	225	270	73.5	15	158	114	1 1/4"	1"	23
CB/200	345	225	270	73.5	15	158	114	1 1/4"	1"	24
CB/300	345	225	270	73.5	15	158	114	1 1/4"	1"	25
CB/400	345	266	305	95.5	14	135	135	1 1/2"	1 1/4"	41
CB/550	345	266	305	95.5	14	135	135	1 1/2"	1 1/4"	45
CB/750	345	266	305	95.5	14	135	135	1 1/2"	1 1/4"	50

PERFORMANCE CURVES CB

(according to ISO 9906 grade 2)

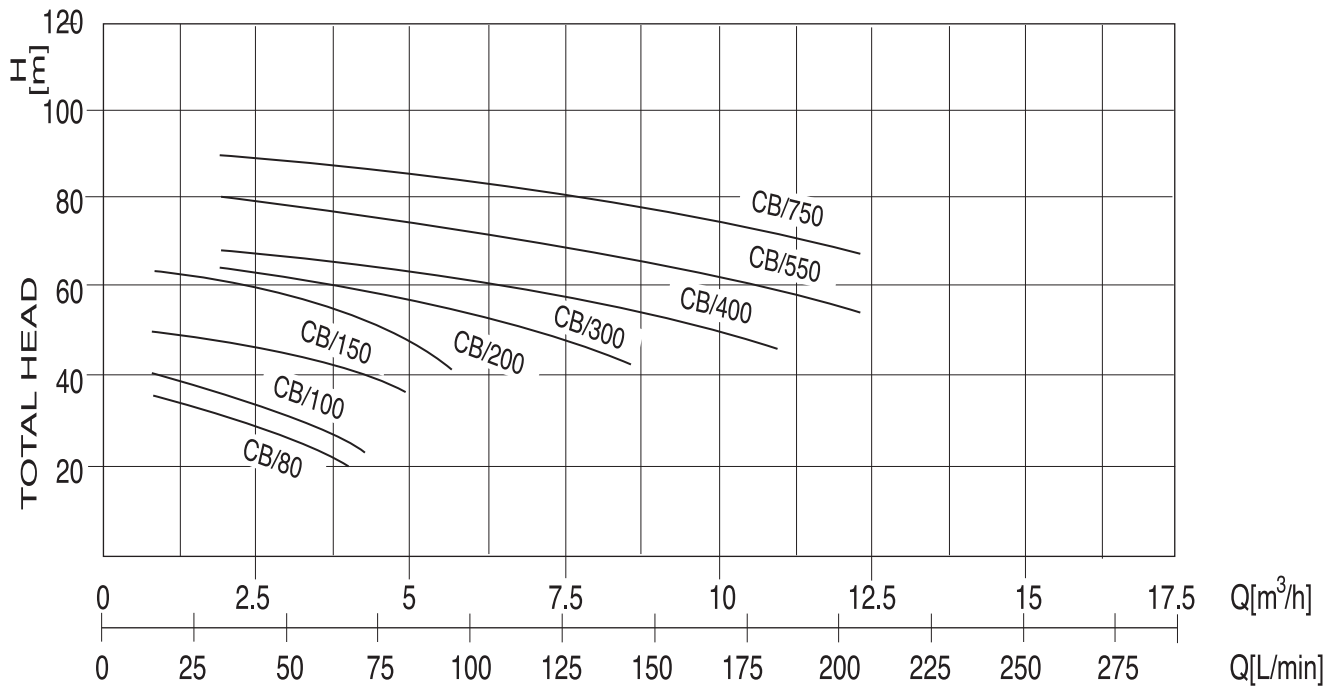

SELECTION TABLE

TYPE	POWER		CAPACITOR MF/450V	ABSORBED CURRENT (A)				Q = Capacity											
	HP	KW		230V-M	230V-T	400V-T	690V-T	M³/H LT/MIN	1,2	2,4	3,6	4,8	6	7,2	8,4	9,6	10,8	12	
									20	40	60	80	100	120	140	160	180	200	
CB/80	0,75	0,55	16	4,5	2,6	1,5	-	H = HEAD (MT)	35	30	24	20							
CB/100	1	0,74	20	5,2	3,2	1,8	-		41	35	27	24							
CB/150	1,5	1,1	31,5	8	4,8	3	-		51	46	40	35	26						
CB/200	2	1,5	40	11,5	6,4	3,8	-		64	60	55	48	41	33					
CB/300	3	2,2	-	-	9,2	5,2	-		67	63	60	56	51	48	44				
CB/400	4	3	-	-	14	8	-		70	69	66	63	59	56	53	49	45		
CB/550	5,5	4	-	-	17	10	-		81	80	78	76	72	69	66	62	58	53	
CB/750	7,5	5,5	-	-	-	11,5	6,7		91	89	85	83	81	79	77	74	71	67	