

Twin impeller centrifugal pumps with hydraulic components manufactured from stainless steel AISI 304, suitable for pressure boosting, water supply, water treatment & irrigation. Air conditioning systems and general water pumping including moderately aggressive liquids.



### SPECIFICATIONS

- \* Maximum working pressure: 8 bar
- \* Maximum liquid temperature:  
35 °C according EN 60335-2-41 for domestic uses  
60 °C for other uses 110 °C for H version

### MATERIALS

- \* Pump body, impeller, diffuser and casing cover in AISI 304
- \* Shaft in AISI 303
- \* Bracket and motor casing in alluminium
- \* Mechanical seal in carbon/ceramic/NBR
- \* Special mechanical seal are available on demand

### TECHNICAL DATA

- \* T.E.F.C. 2 poles motor
- \* Insulation class F
- \* Protection degree IP55
- \* 1~230V ± 10% 50Hz, 3~230/400V ± 10% 50Hz
- \* Permanent split capacitor and automatic thermal overload protection for single-phase version
- \* Thermal protection to be provided by the user for three-phase version

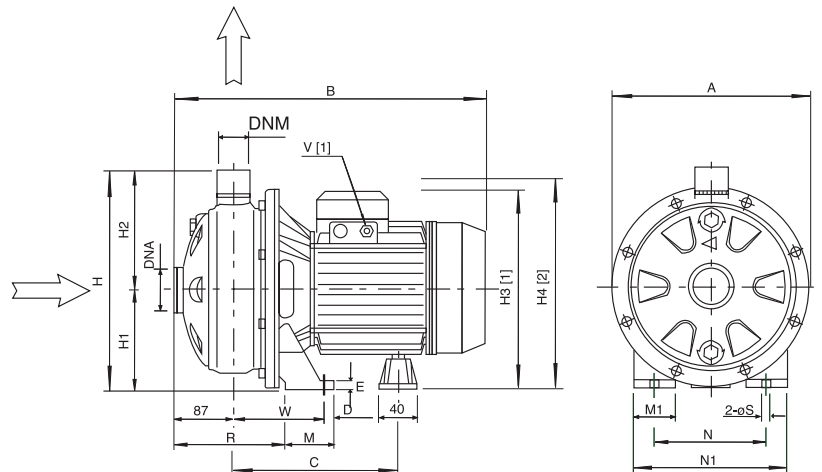

### DIMENSIONAL TABLE

Pump type		Dimensions (mm)																			Weight Kg			
		A	B	C	D	E	H	H1	H2	H3	H4	M	M1	N	N1	R	T	V	W	S	DNA	DNM	Single-phase	Three-phase
Single-phase	Three-phase									1~	3~						1~	3~						
CBX/100	CBX/100	208	355	182	12.5	8	229	106	123	209	215	50	38	120	160	142.5	PG11	PG11	93	9	1 1/4"	1"		
CBX/120	CBX/120	208	355	182	12.5	8	229	106	123	209	215	50	38	120	160	142.5	PG11	PG11	93	9	1 1/4"	1"	13.5	13.3
CBX/150	CBX/150	232	380	199	12.5	8	250	118	132	235	249	55	40	140	180	140	PG13.5	PG11	95.5	9	1 1/4"	1"	14.2	13.8
CBX/200	CBX/200	232	385	199	12.5	8	250	118	132	235	249	55	40	140	180	140	PG13.5	PG11	95.5	9	1 1/4"	1"	17.4	16.4
CBX/150A	CBX/150A	208	380	199	12.5	8	229	106	123	223	237	55	40	140	180	140	PG13.5	PG11	95.5	9	1 1/4"	1"	18.6	18.2
CBX/200A	CBX/200A	208	380	199	12.5	8	229	106	123	223	237	55	40	140	180	140	PG13.5	PG11	95.5	9	1 1/4"	1"	15.5	15.3
	CBX/300	232	390	209.5	12.5	8	250	118	132	240	-	65	40	140	180	145	-	PG13.5	110.5	9	1 1/4"	1"	18.0	16.9
	CBX/400	232	420	231.5	12.5	8	250	118	132	240	-	65	40	140	180	145	-	PG13.5	110.5	9	1 1/4"	1"	-	23.2
	CBX/300A	208	420	231.5	12.5	8	241	118	132	240	-	55	40	140	180	145	-	PG13.5	100.5	9	1 1/2"	1"	-	26.4
	CBX/400A	232	420	231.5	12.5	8	250	118	132	240	-	65	40	140	180	145	-	PG13.5	110.5	9	1 1/2"	1"	-	25.0
	CBX/500	232	445	231.5	16.0	13	250	118	132	252	-	68	50	160	210	145	-	PG16	110.0	12	1 1/2"	1"	-	25.0

# PERFORMANCE CURVE

( according to ISO 9906 grade 2)

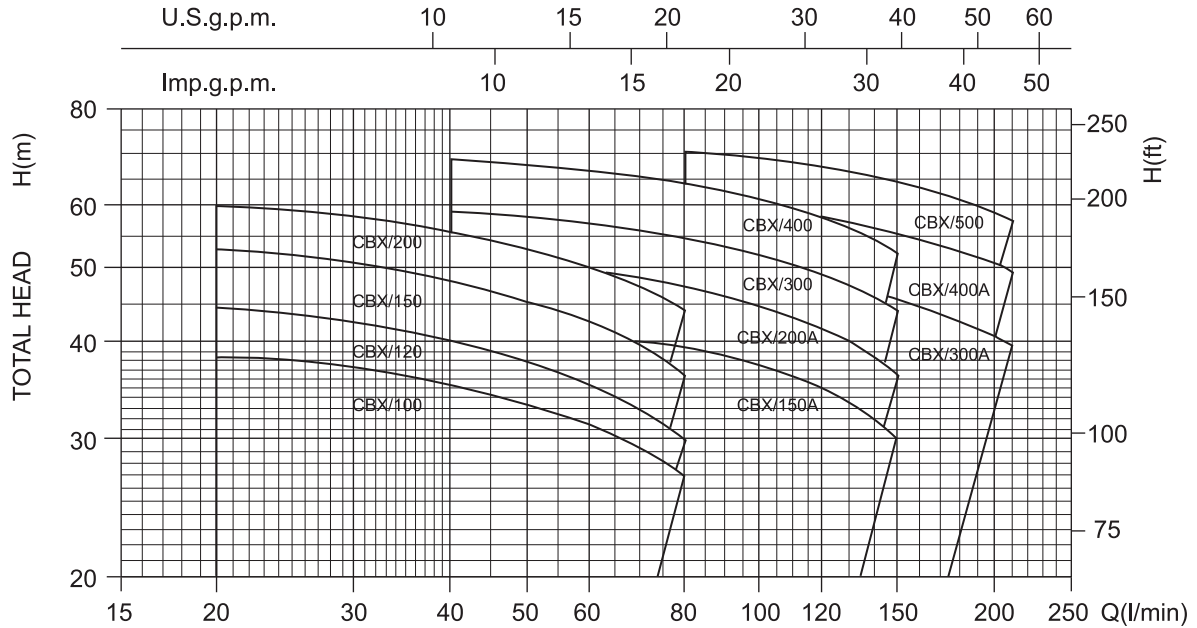

PERFORMANCE TABLE

Pump type		kW	Capacitor		Absorbed Current (A)			l/min m <sup>3</sup> /h	Q=Capacity								
Single-phase 230V 50Hz	Three-phase 230/400V 50Hz		µF	Vc	Single-phase	Three-phase 230V 400V			1,2 20	2,4 40	3,6 60	4,8 80	7,2 120	9 150	10,8 180	12,6 210	
CBX/100	CBX/100	0.75	20	450	6.0	4.0	2.3	H/MT	39	35	32	27					
CBX/120	CBX/120	0.9	31.5	450	7.0	5.0	2.9		45	40	36	30					
CBX/150	CBX/150	1.1	35	450	8.0	5.6	3.2		53	48	43	37					
CBX/200	CBX/200	1.5	40	450	9.9	7.0	4.0			42	41	40	35	30			
CBX/150A	CBX/150A	1.1	35	450	8.3	5.6	3.2		60	56	50	44					
CBX/200A	CBX/200A	1.5	40	450	10.2	7.0	4.0			52	50	47	42	37			
	CBX/300	2.2	-	-	-	8.7	5.0			59	57	55	49	44			
	CBX/400	3.0	-	-	-	10.8	6.2				52	51	48	46	43	40	
	CBX/300A	2.2	-	-	-	10.4	6.0			69	67	64	58	52			
	CBX/400A	3.0	-	-	-	11.4	6.6				63	61	58	55	52	49	
	CBX/500	3.7	-	-	-	15	8.7				72	70	67	64	61	58	

# PERFORMANCE CURVES CBX 100-200

( according to ISO 9906 grade 2 )

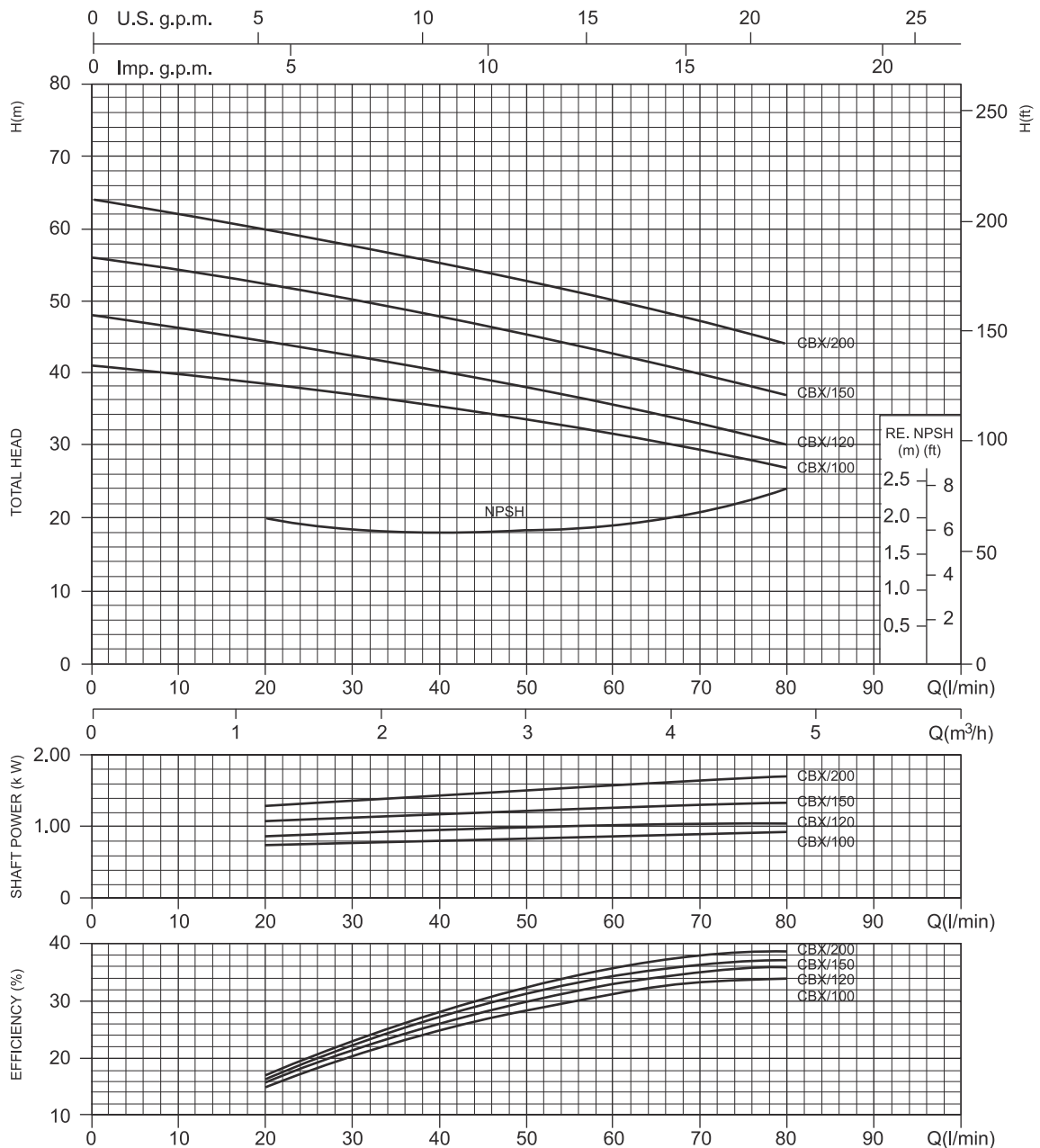

# PERFORMANCE CURVES CBX 150A-400

( according to ISO 9906 grade 2)

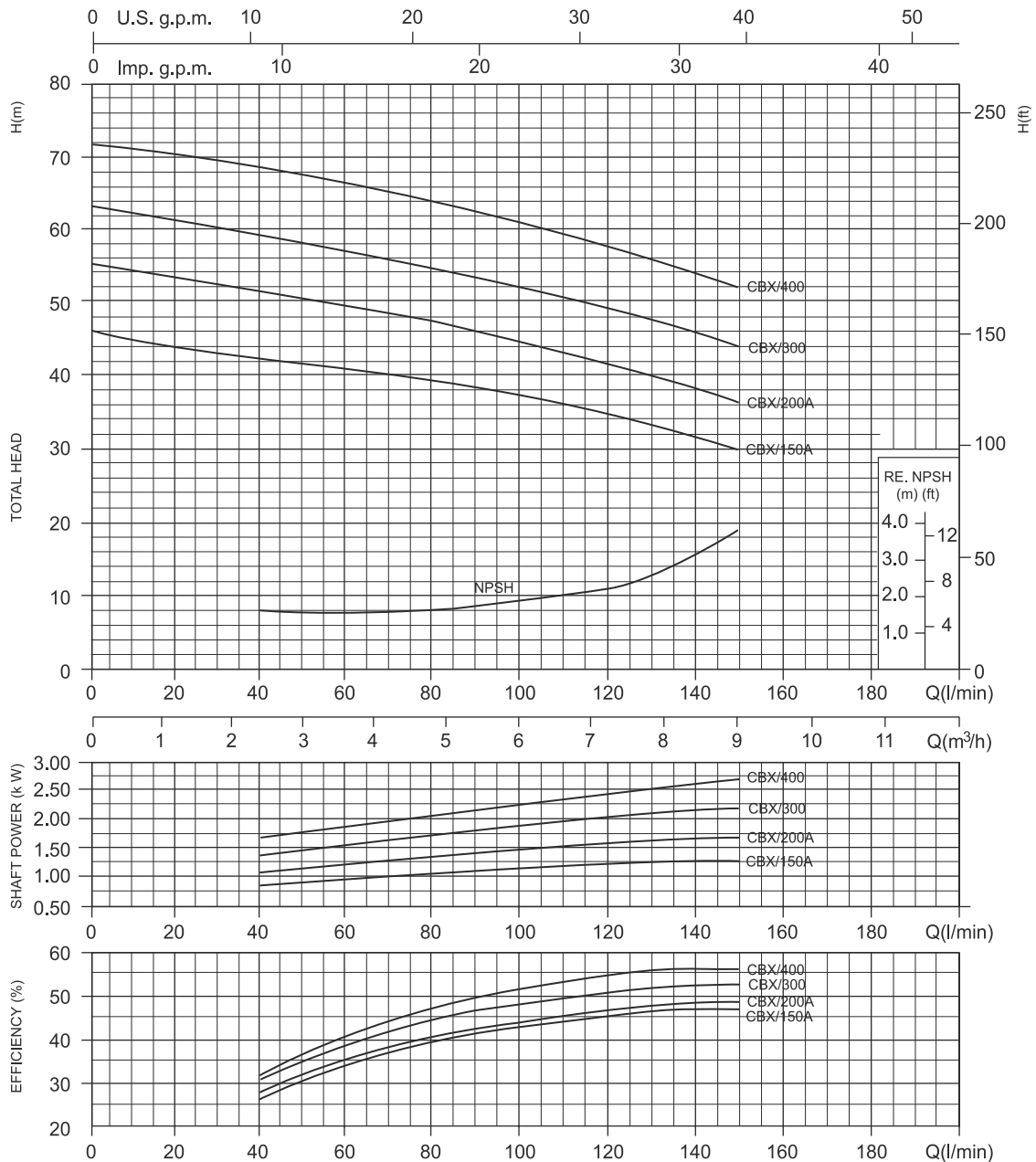

# PERFORMANCE CURVES CBX 300A-500

( according to ISO 9906 grade 2)

